

# Phasing Preferred Option

- 1. Existing
- 2. Phase 1: Build the new arts venue
  - Former working men's club demolished
  - New public realm connecting to High Street car park built
  - New arts venue built
  - Existing Bonington Theatre closed
- 3. Build the new leisure centre & library
  - Existing library and leisure centre remain open throughout construction
  - 155-159 Front Street demolished
  - New library constructed
  - New leisure centre constructed
  - Public realm created to link High Street and Front Street
- 4. Demolish the existing buildings
  - Demolish the existing library and leisure centre
  - Build a new High Street car park
  - Create a new community garden next to the library
  - Create a new child's play area and active travel hub
  - Improve access to Druid's Tavern Car Park

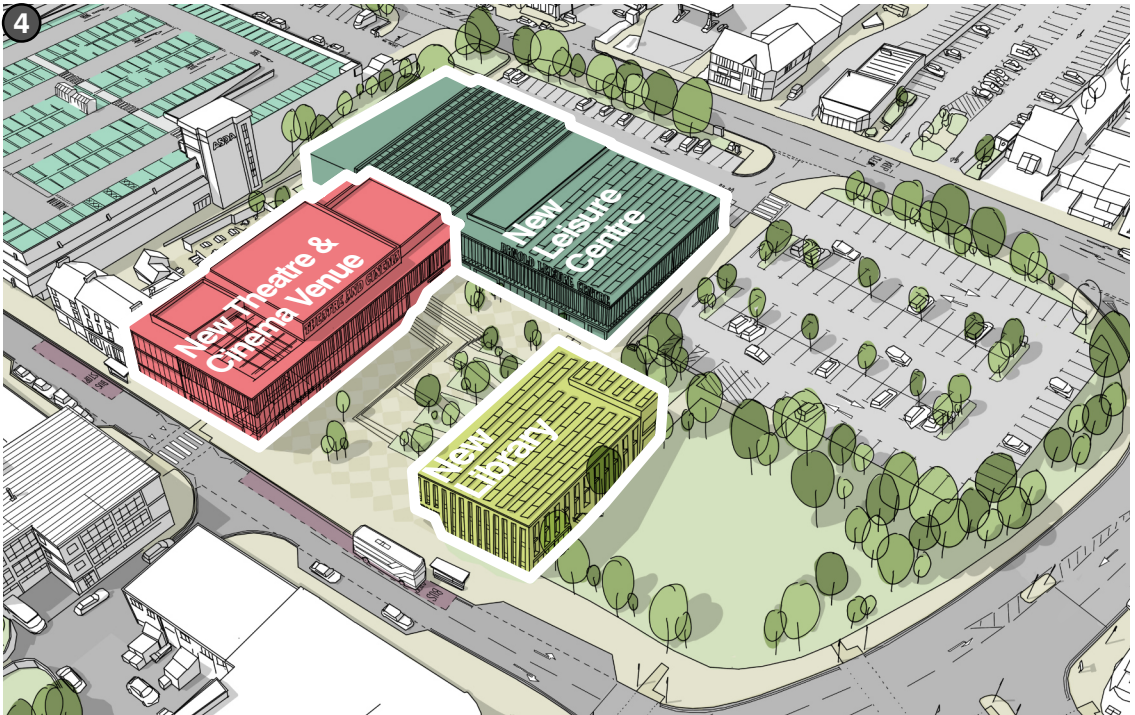

- Arts Venue
- Leisure Centre
- Library

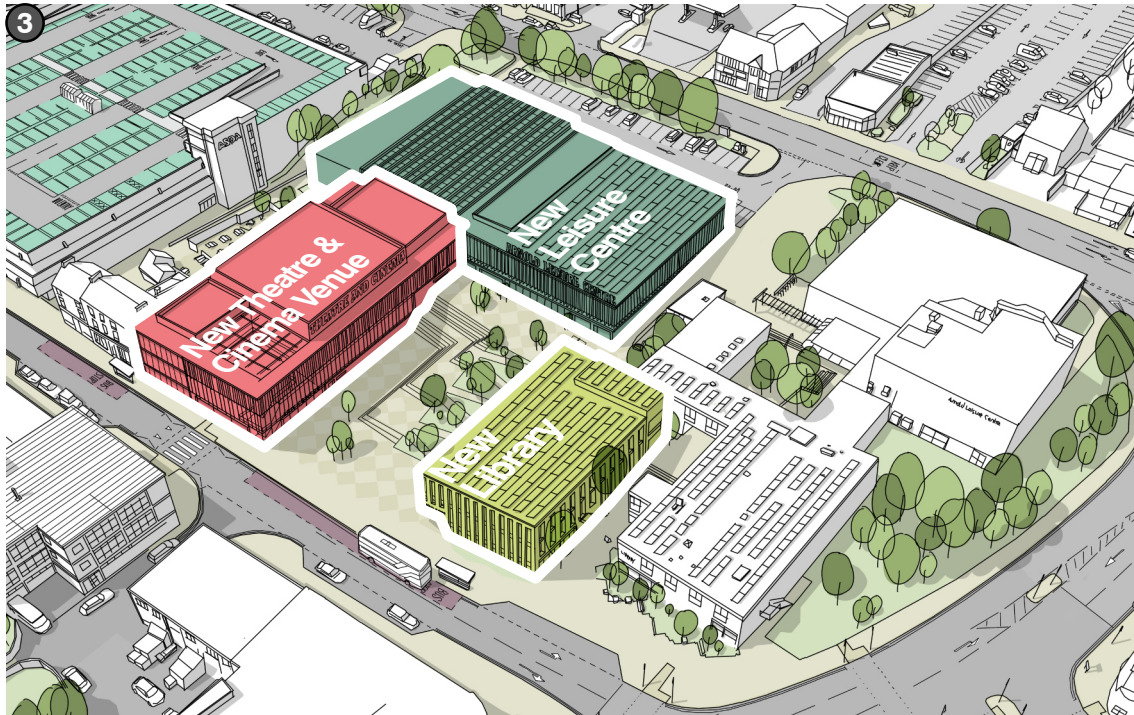
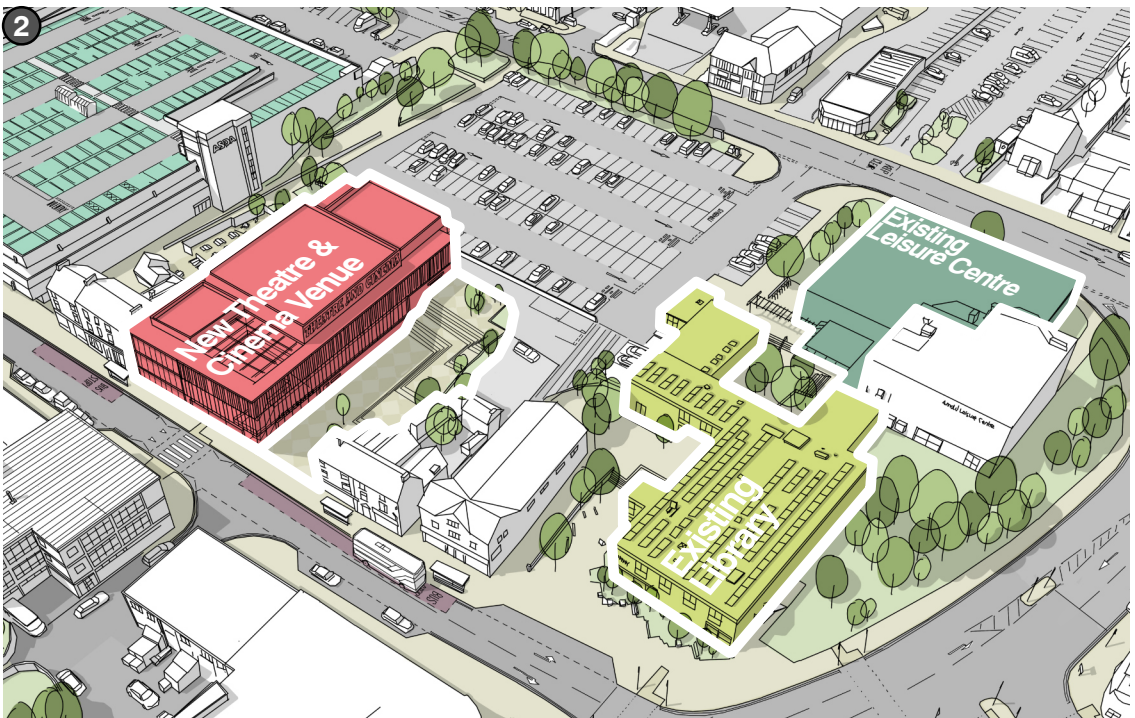
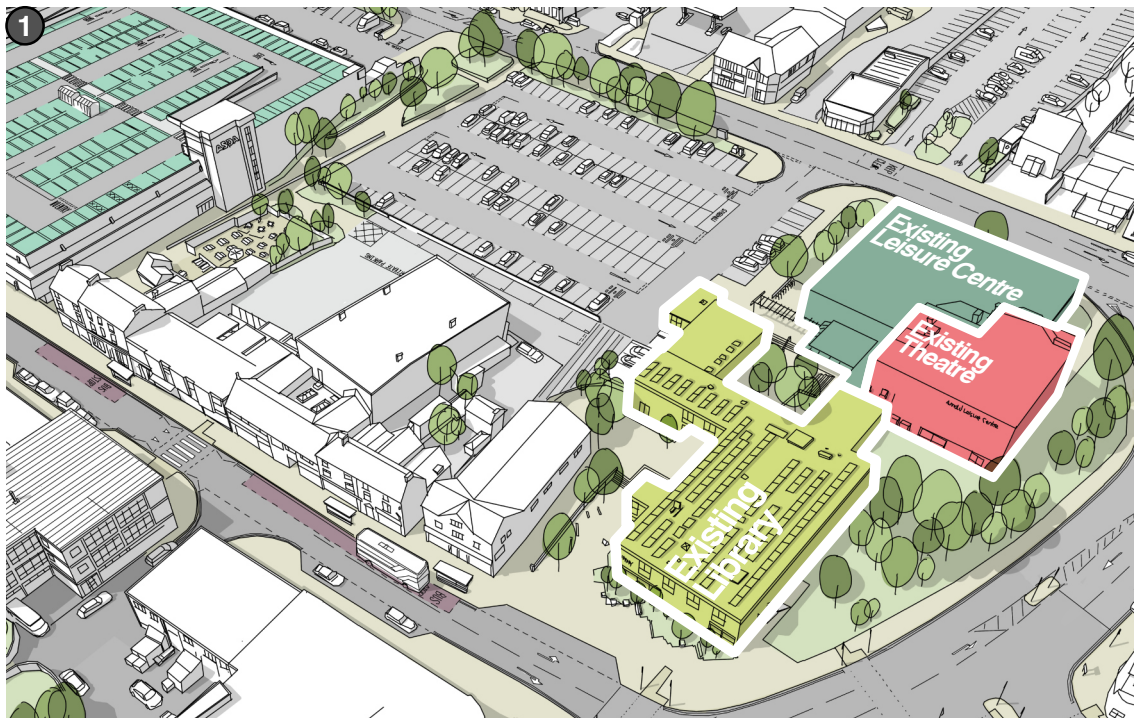

# Phasing

## Alternative Option A

- 1. Existing
- 2. Phase 1: Build the new arts venue
  - Former working men's club demolished
  - New public realm connecting to High Street car park built
  - New arts venue built
  - Existing Bonington Theatre closed
- 3. Build the new Leisure Centre
  - Existing leisure centre remains open throughout construction
  - Relocate the library substation to the north of the existing building
  - Demolish the existing substation & bridge link
  - 155-157 Front Street demolished
  - New leisure centre constructed
  - Public realm created to link High Street and Front Street via a public square
  - Create a new child's play area and active travel hub in the centre of the site
- 4. Demolish the existing leisure centre
  - Demolish the existing leisure centre
  - Build a new High Street car park
  - Improve access to Druid's Tavern Car Park

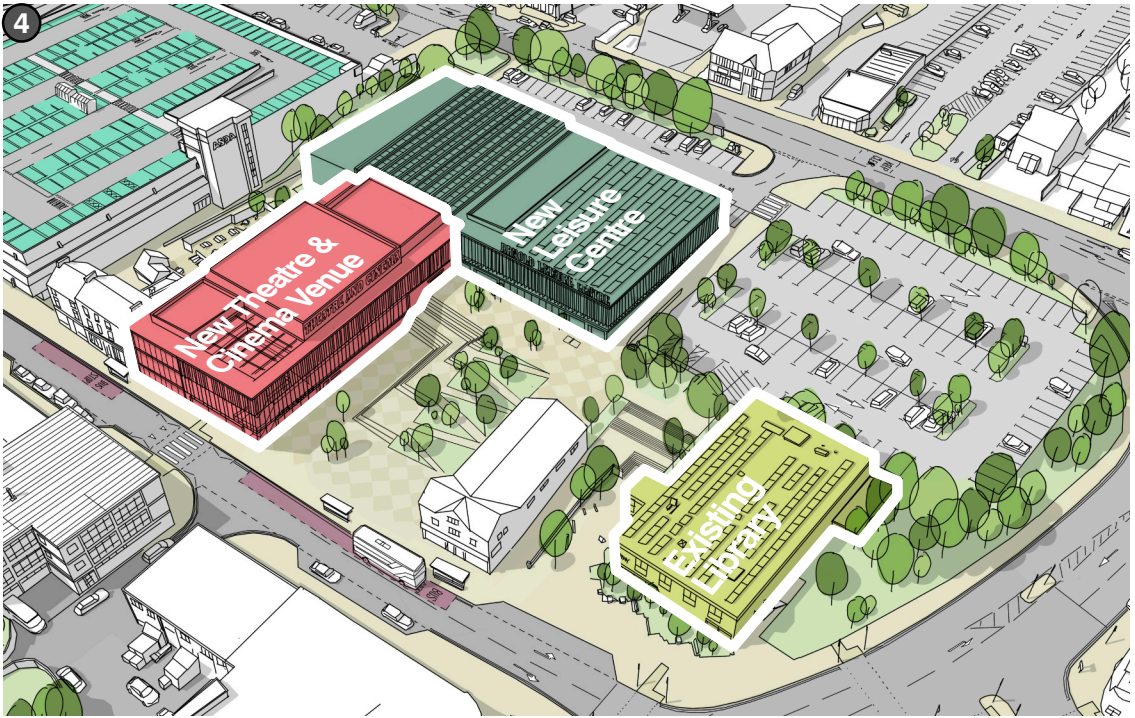
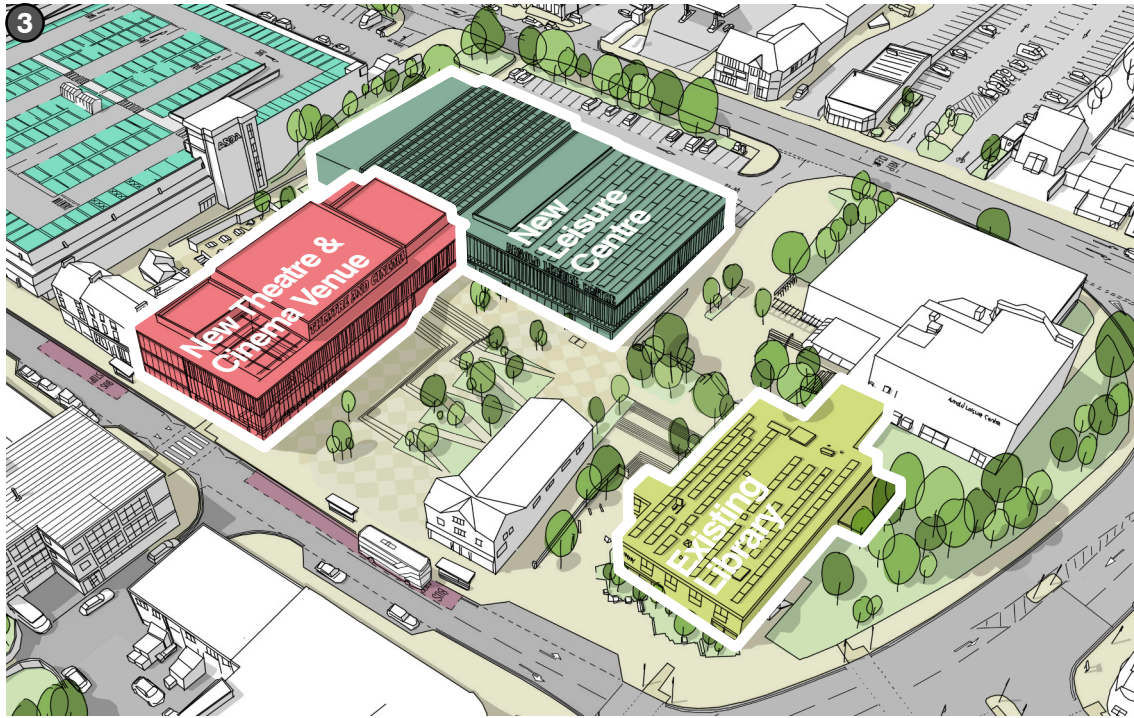
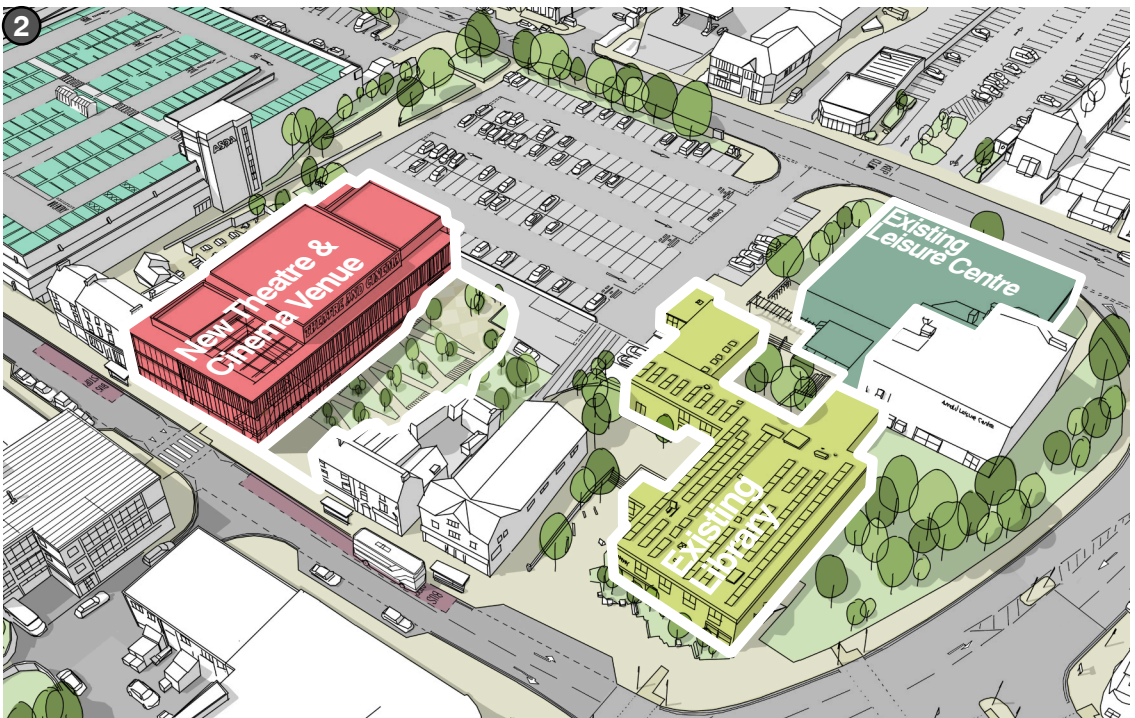
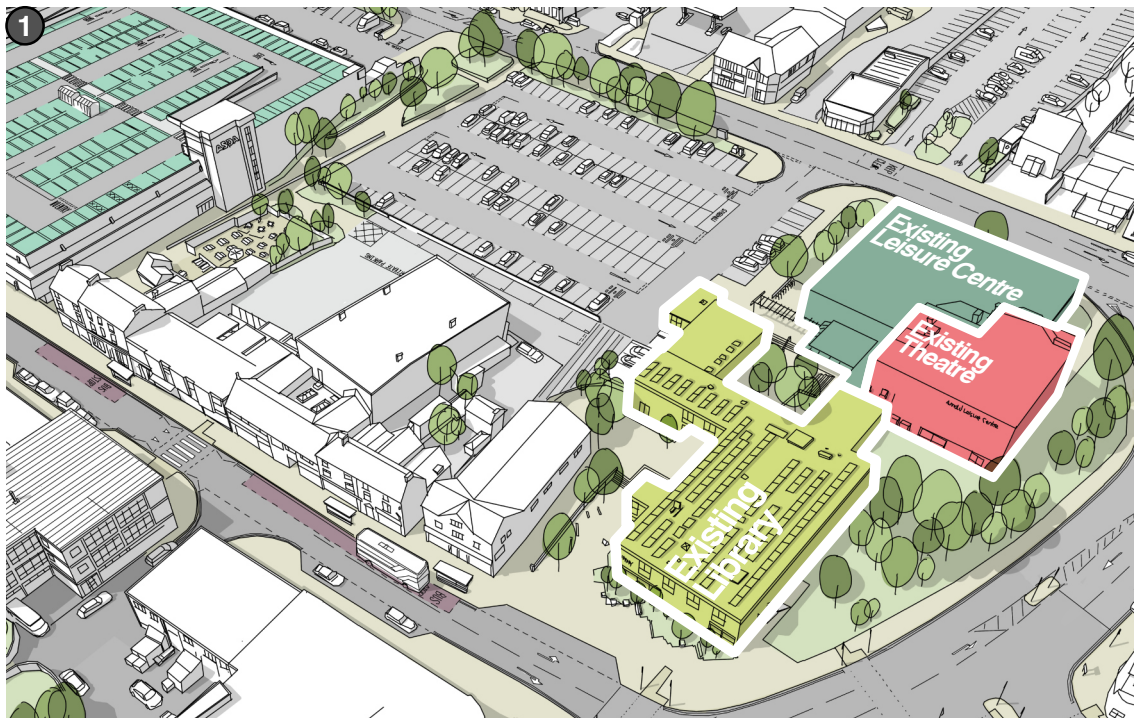



# Phasing

## Alternative Option B

- 1. Existing
- 2. Phase 1: Build the new arts venue
  - Former working men's club demolished
  - New public realm connecting to High Street car park built
  - New arts venue built
  - Existing Bonington Theatre closed
- 3. Build the new leisure centre
  - Existing leisure centre remains open throughout construction
  - Relocate the library substation to the north of the existing building
  - Demolish the existing substation & bridge link
  - New leisure centre constructed
  - Create a new child's play area and active travel hub in the centre of the site
- 4. Demolish the existing leisure centre
  - Demolish the existing leisure centre
  - Build a new High Street car park
  - Improve access to Druid's Tavern Car Park

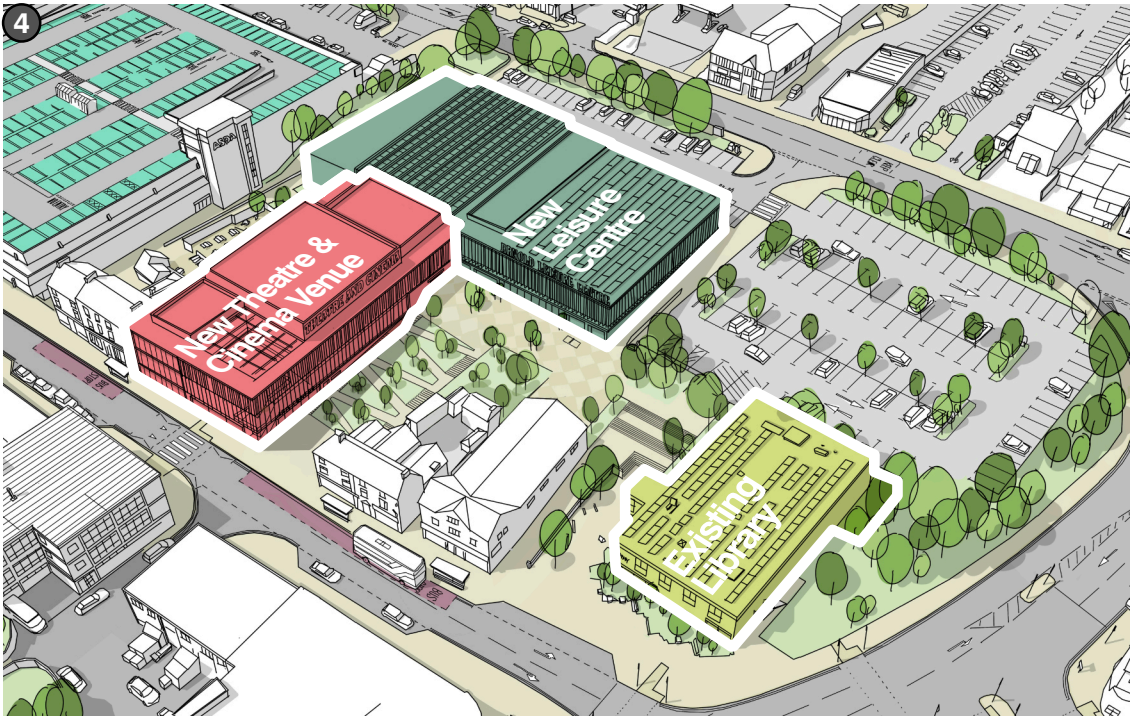
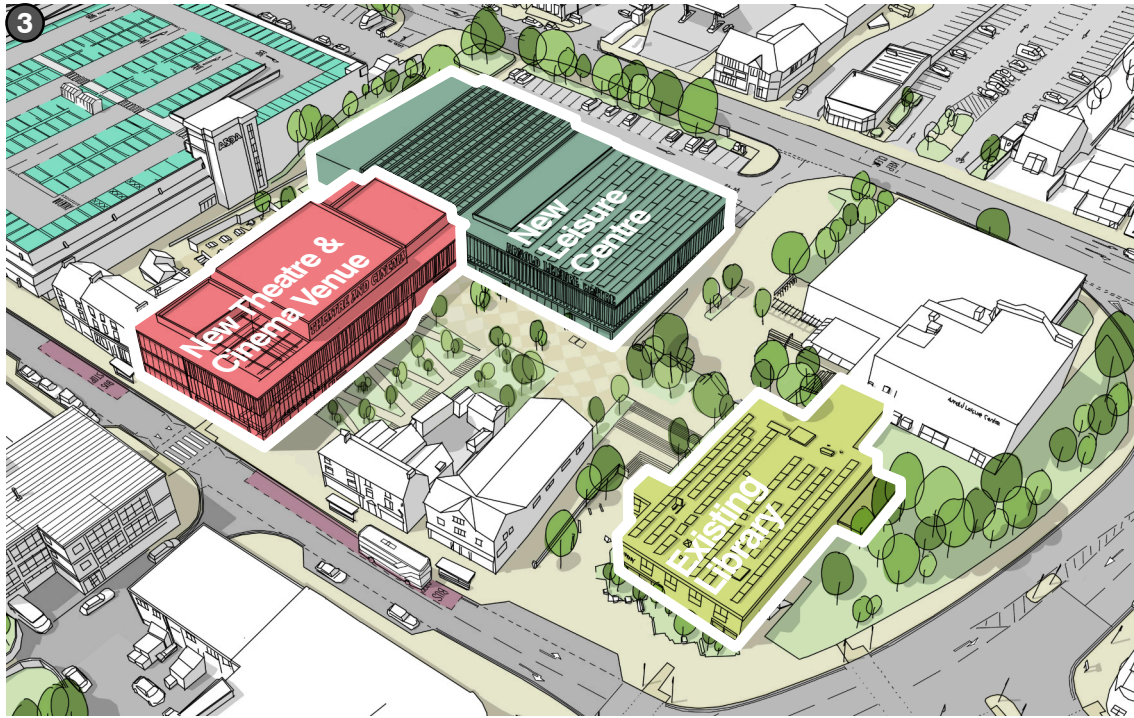
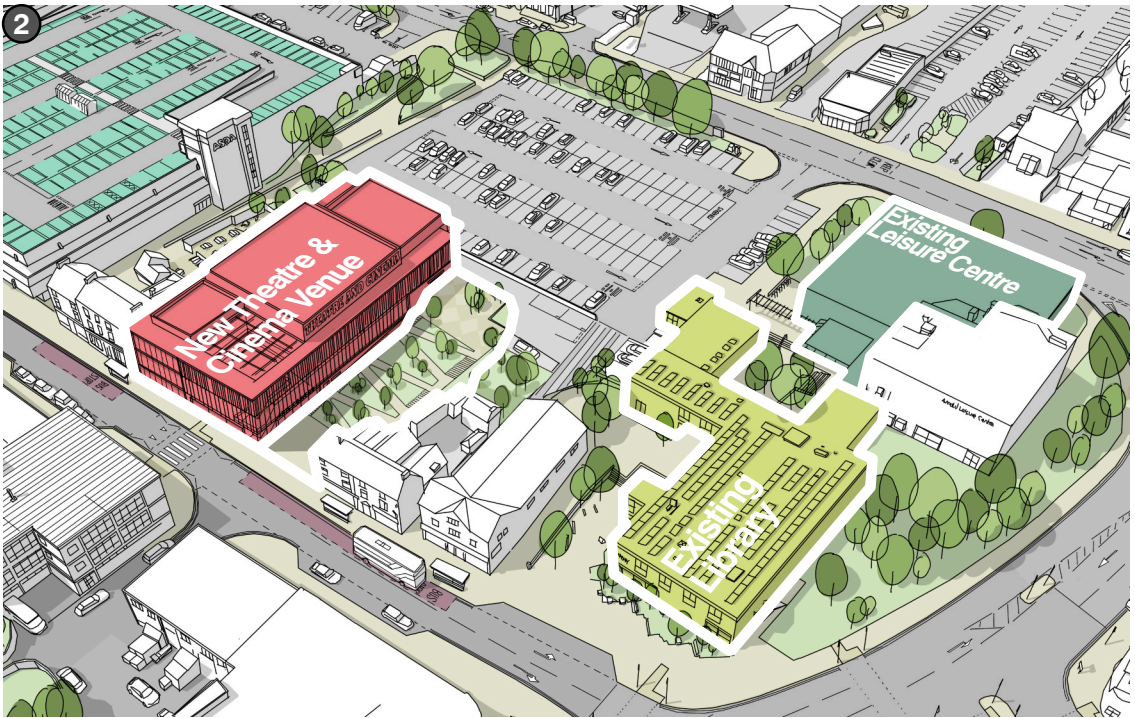
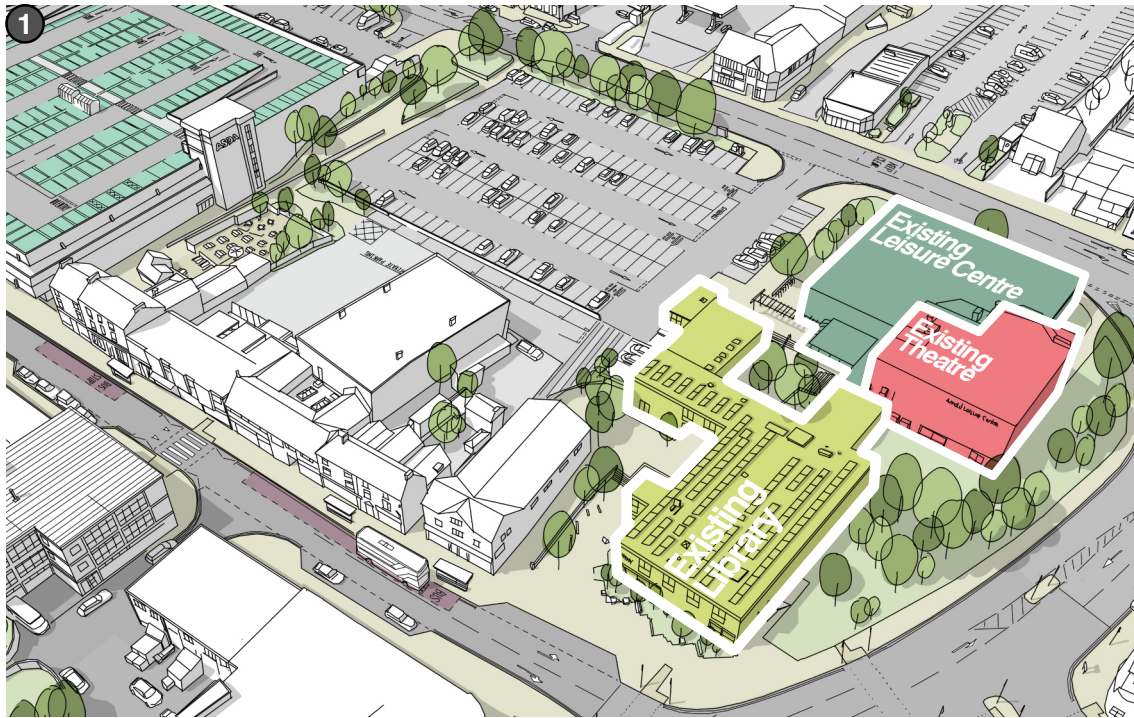

Arts Venue ■  
Leisure Centre ■  
Library ■



# Phasing

## Retaining the Library

- Opportunity for plant room relocation (subject to County Council agreement).
- Scope for MEP upgrades and decarbonisation.

- 1. Existing**  
Existing library substation
- 2. Library substation relocated**  
New arts venue and leisure centre constructed.  
Relocate the library substation to the north of the existing building.
- 3. Demolish the existing substation & bridge link**  
Demolish the existing theatre and leisure centre  
Demolish substation & bridge link
- 4. Make good the existing facade, explore opportunities to decarbonise & update**  
Potential to update existing library facade and make good walls where substation & bridge link were demolished  
Served from new car park

